

Staged Offset Tool Z6

Staged Offset Tool Z8

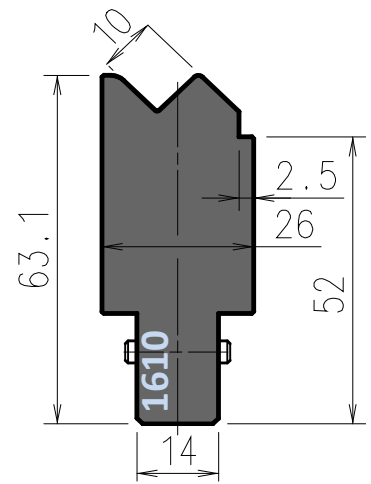
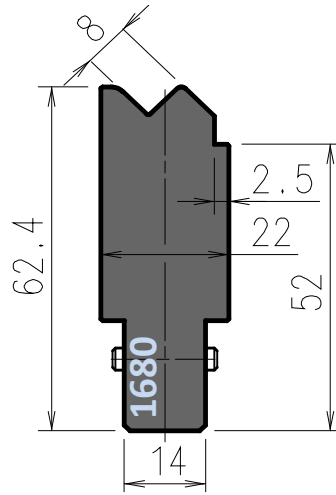
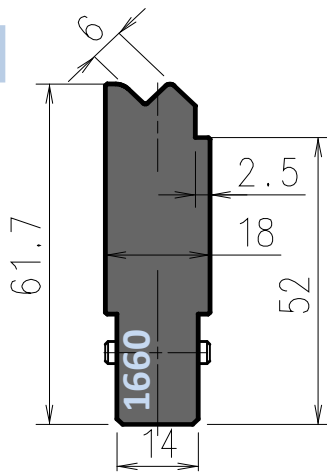

Staged Offset Tool Z10

1000 kN/m



Tool 1660 replaces old tool SZ06

Length mm	Item No.	Weight Kg
835	ED1660101	6,4
415	ED1660102	3,2
800 sect.	ED1660103	6,1

90° angled 	t_{max} = 1,5mm (acc. to V=8,5mm).
Obtuse ang. 	t_{max} = 1,75mm

Tool 1680 replaces old tool SZ08

Item No.	Weight Kg
ED1680101	7,5
ED1680102	3,7
ED1680103	7,2

t_{max} = 1,75mm (acc. to V≈11mm).
t_{max} = 2mm

Tool 1610 replaces old tool SZ10

Item No.	Weight Kg
ED1610101	8,6
ED1610102	4,3
ED1610103	8,2

t_{max} = 2mm (acc. to V≈14mm).
t_{max} = 2mm

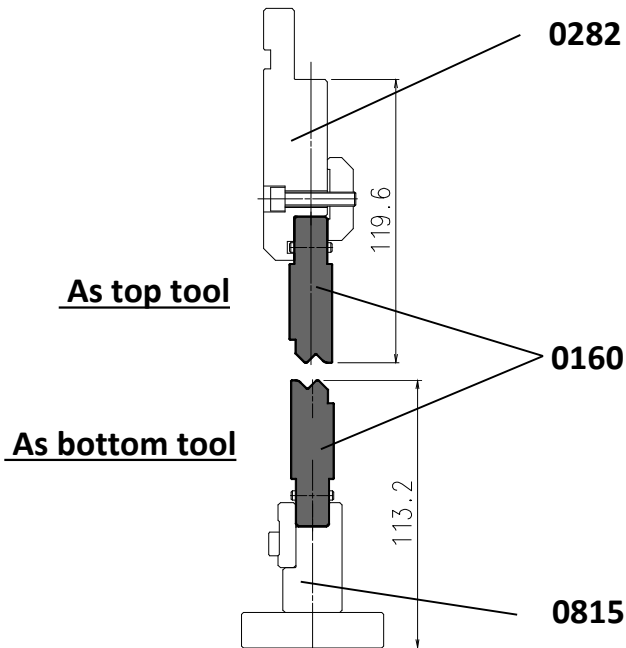

Note:

- Staged offset tools are reversible and can be mounted on a punch or die holder
- Offset bending involves high thrust forces, therefore max. tooling length in staging (depending on mat. thickness) is around 500mm
- Use with holder 0282 for H=90mm and with 0582 for H=120mm punch height
- Two of each code are required when ordering a punch and die set